

METROPOLITAN COMMUNITY COLLEGE

PUBLIC SAFETY 457-2313
Information 457-2400

Severe Weather Shelter areas

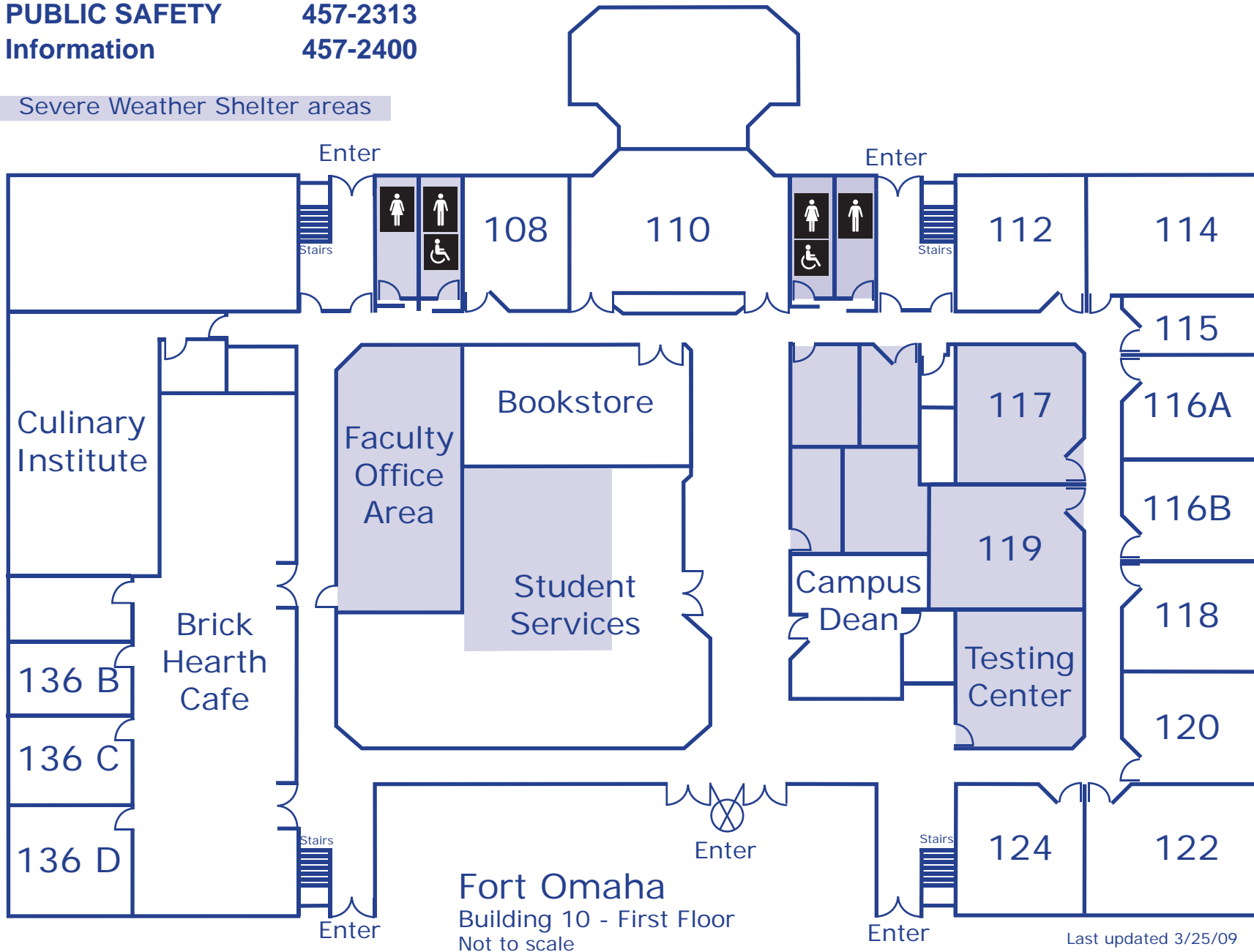

METROPOLITAN COMMUNITY COLLEGE

**PUBLIC SAFETY
Information**

**457-2313
457-2400**

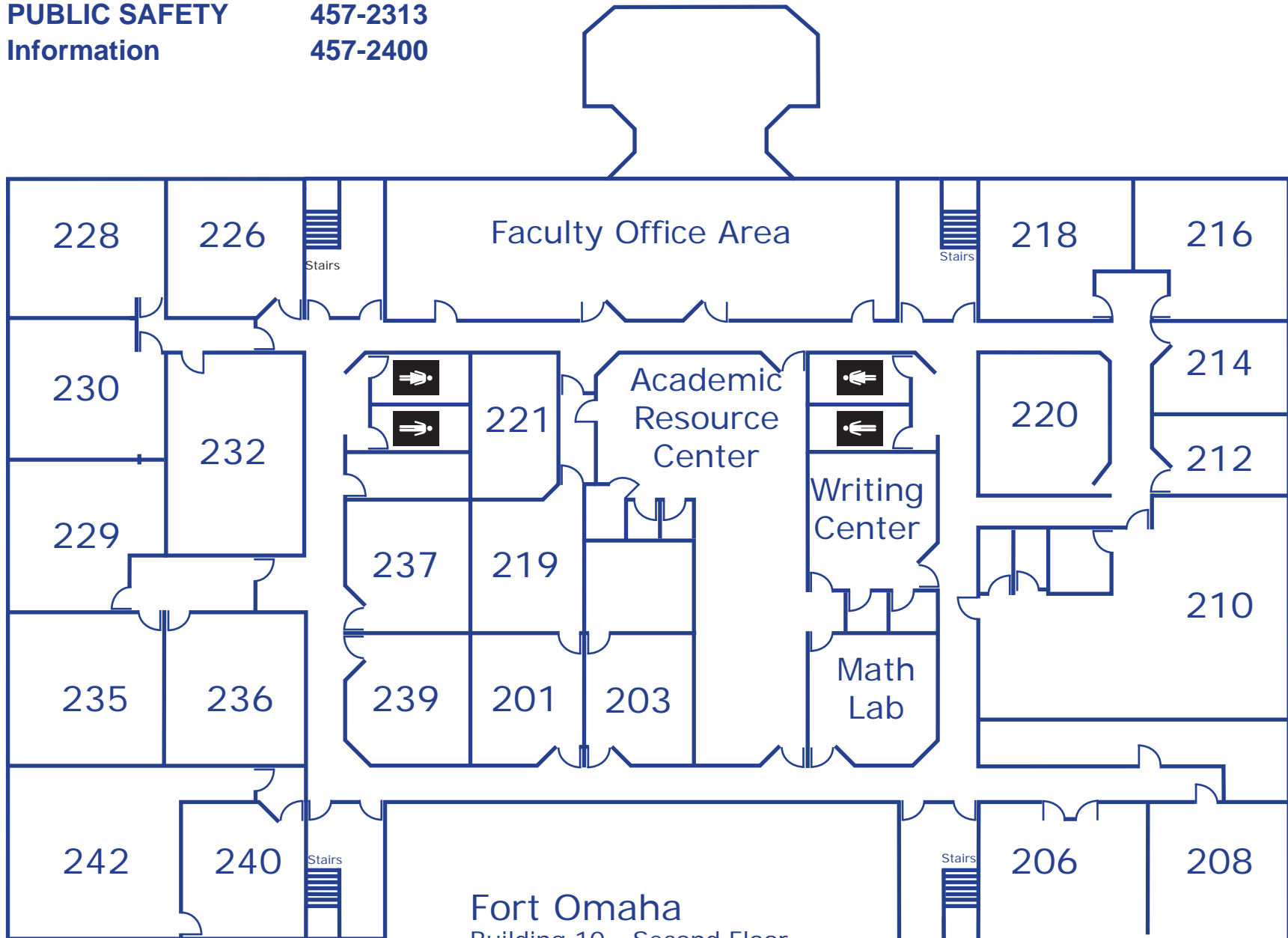

Fort Omaha
Building 10 - Second Floor
Not to scale

Last updated 3/25/09